

7-Shaped Through-Hole DC Gear Motor Specification

Custom L-shaped through-hole gear motor for ultra-thin smart angle-adjustable track lights.

	<h3>Product Overview</h3> <p>This compact DC gear motor uses an L-shaped vertical motor and gearbox layout with a gearbox through-hole. It is designed for tight installation cavities in ultra-thin track light products.</p> <ul style="list-style-type: none"> - Application: smart angle-adjustable track lights - Structure: 7-shaped / L-shaped through-hole gearbox - Rated voltage: 6 V DC - Reduction ratio: 1:152 - Default output rotation: CCW when the positive lead is connected to motor + terminal
---	---

Dimensional Drawing

Reference mechanical outline. Dimensions are shown in millimeters unless otherwise specified.

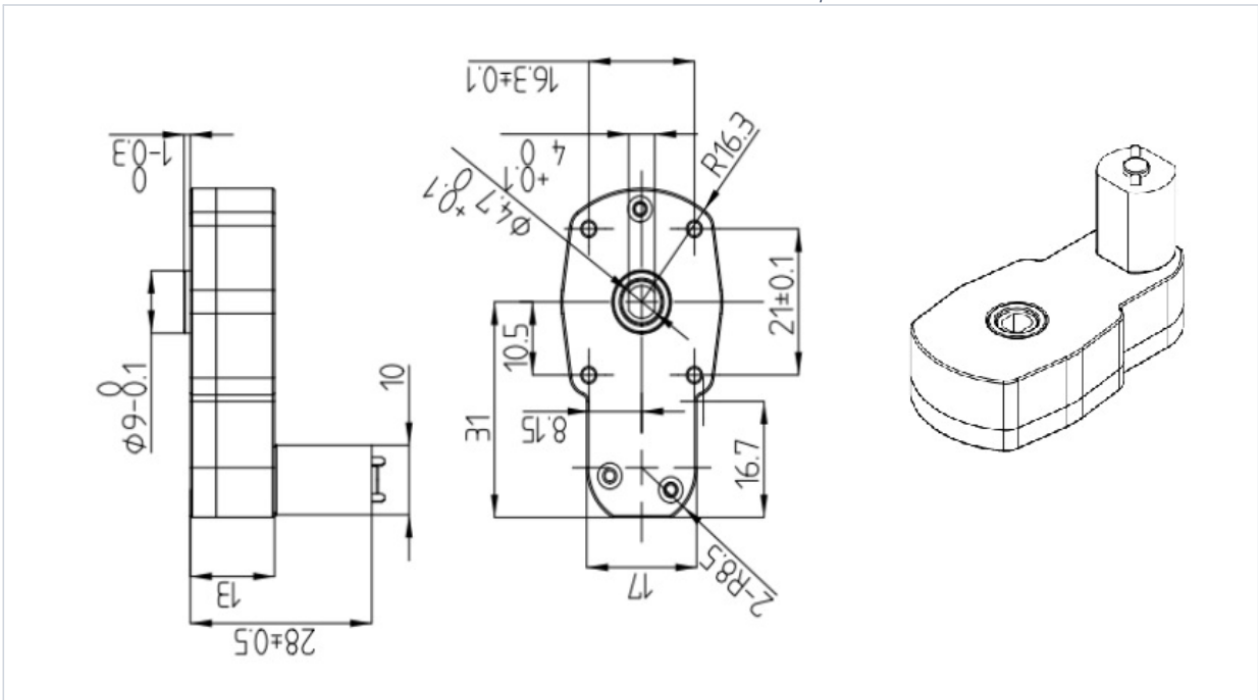

Key Feature	Description
Compact layout	Vertical L-shaped structure fits narrow and ultra-thin lamp cavities.
Through-hole gearbox	Supports shaft installation and internal wiring route planning.
High reduction ratio	1:152 gear reduction supports stable angle adjustment and holding performance.

Electrical and Mechanical Specifications

Parameters are for reference only. Final specifications can be customized according to customer requirements.

Parameter	Specification	Parameter	Specification
Reduction Ratio	1:152	Rated Voltage	6 V DC
No Load Speed	120 +/- 10% RPM	No Load Current	<= 150 mA
Rated Speed	100 +/- 10% RPM	Rated Current	<= 200 mA
Rated Torque	0.2 kgf.cm	Stall Current	<= 800 mA
Stall Torque	>= 1.5 kgf.cm	Stall Allowed	No
Default Rotation	CCW at output shaft	Terminal Condition	Positive lead to motor + terminal

Operating Notes

- Do not use the motor under continuous stall conditions.
- The output shaft rotates counterclockwise by default when the power positive lead is connected to the motor + terminal.
- Electrical values may vary with load, temperature, installation method, and duty cycle.
- Final validation should be completed in the customer application before mass production.

Customization Capability

Tsinglin Micro Motors Limited provides one-stop custom micro DC motor solutions. Customization options can include gearbox structure, output interface, through-hole design, reduction ratio, rotation direction, wiring, noise control, current limits, and batch production requirements.

Customization Item	Available Support
Mechanical design	L-shaped layouts, through-hole housings, output shaft interfaces, mounting features, and compact cavity matching.
Performance tuning	Speed, torque, current, reduction ratio, duty cycle, noise, and life-cycle optimization.
Production support	Mold development, sampling, testing, quality control, and stable batch delivery.