

TSL-PG16-KS1625 Series

Micro DC Planetary Gear Motor - Product Specification



SERIES OVERVIEW

- Rated voltage: 12 V DC
- Available planetary ratios: 30:1, 157:1, 850:1 and 4592:1
- 16 mm planetary steel gearbox with coreless brushed DC motor
- Compact construction with dual ball-bearing output support

ELECTRICAL OPTIONS

Model	Rated Voltage	Gear Ratios
TSL-PG16-KS1625	12 V DC	30:1 to 4592:1

All dimensions are in mm unless otherwise specified.

DIMENSIONAL DRAWING

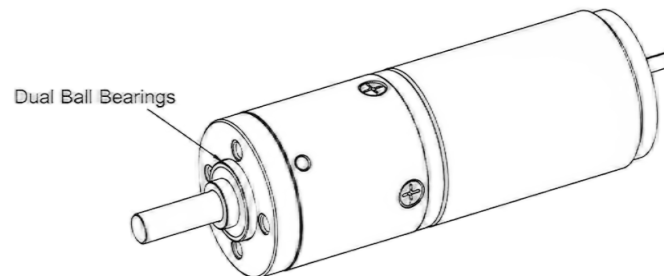
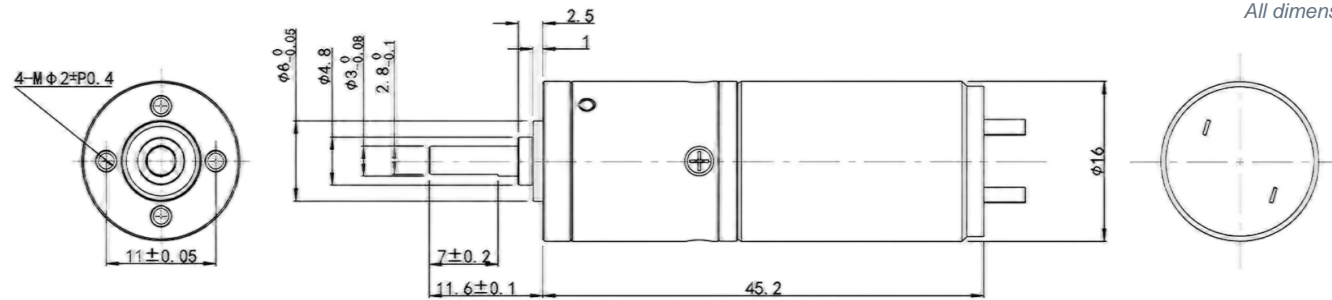

TSL-PG16-KS1625 Series

12 V DC - Performance Data by Gear Ratio

Motor Model	TSL-PG16K30-KS1625	TSL-PG16K157-KS1625	TSL-PG16K850-KS1625	TSL-PG16K4592-KS1625
Reduction Ratio	30	157	850	4592
Rated Voltage (V)	12	12	12	12
No-Load Speed (rpm)	299	55	10	1.89
No-Load Current (mA)	13	14	14.7	16
No-Load Efficiency (%)	56.94	53.07	47.26	28.56
Speed at Maximum Efficiency (rpm)	264	48	9	1.65
Current at Maximum Efficiency (mA)	97	100.2	102.7	108.8
Torque at Maximum Efficiency (gf-cm)	245	1289	6343	22057
Output Power at Maximum Efficiency (W)	0.66	0.64	0.58	0.37
Stall Torque (gf-cm)	2072	105519	506644	171996
Stall Current (mA)	724	717	717	739

Specifications are for reference only. Products can be customized according to customer requirements.

TSL-PG16K30-KS1625

Speed, Current, Output Power and Efficiency vs. Torque

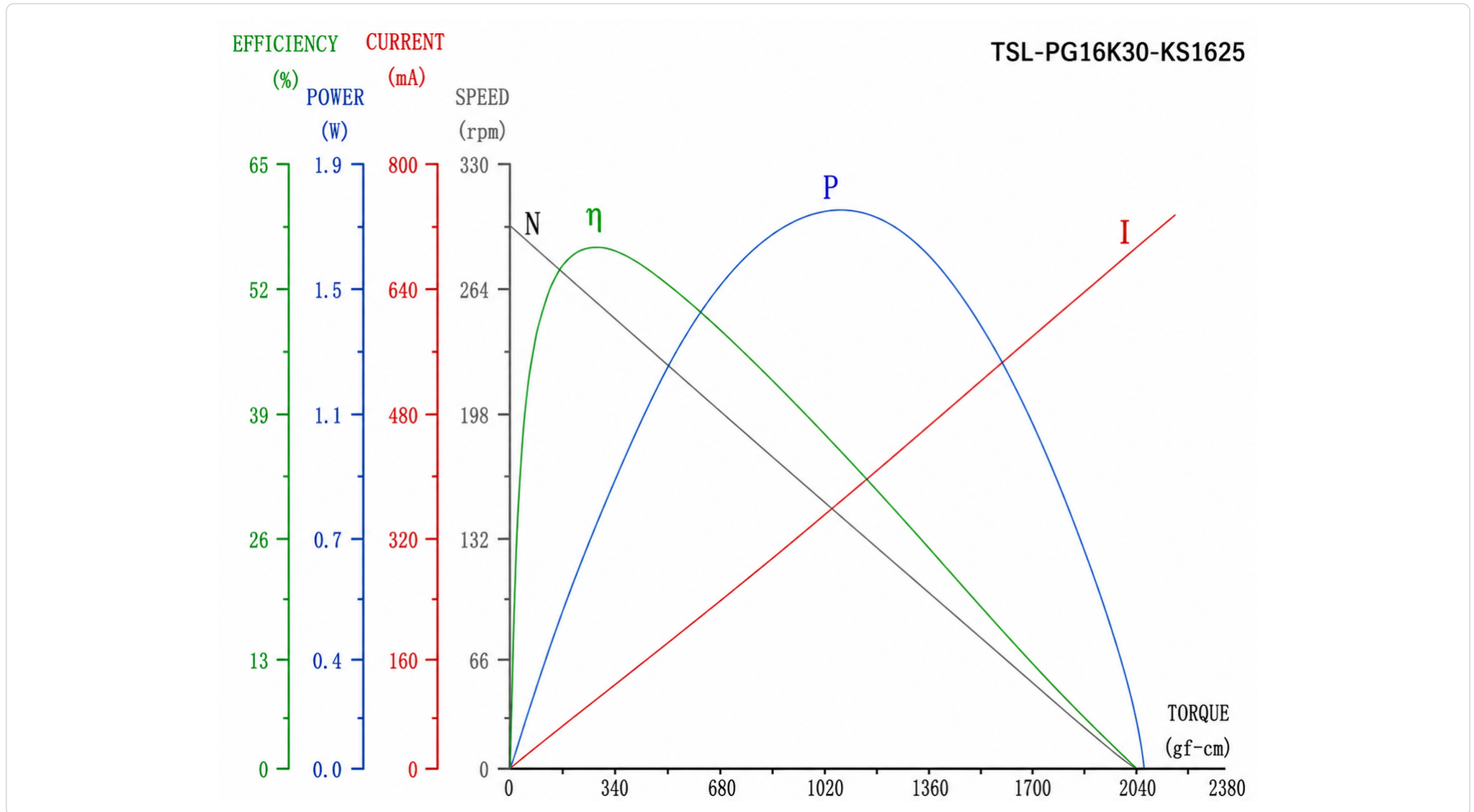

TSL-PG16K157-KS1625

Speed, Current, Output Power and Efficiency vs. Torque

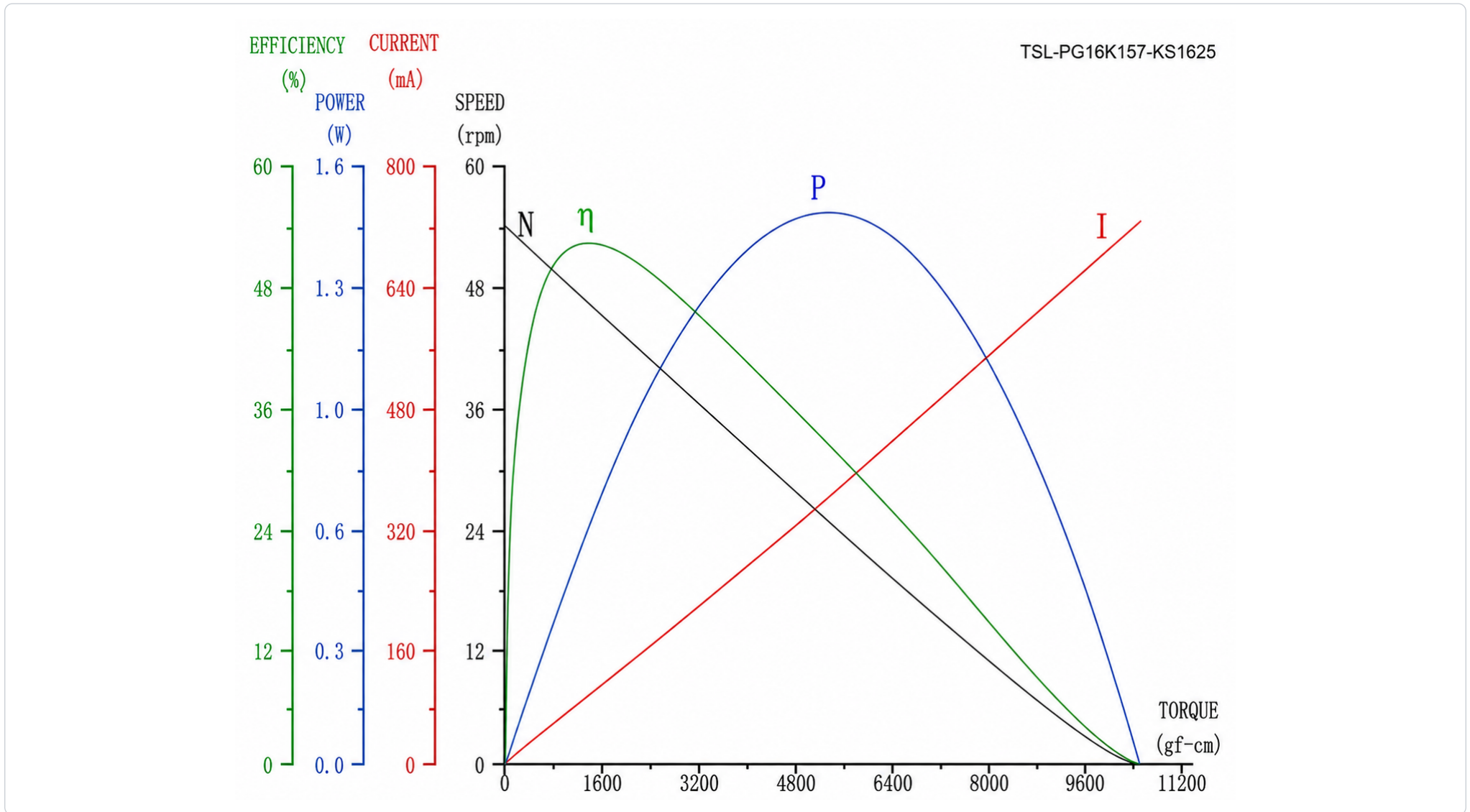

TSL-PG16K850-KS1625

Speed, Current, Output Power and Efficiency vs. Torque

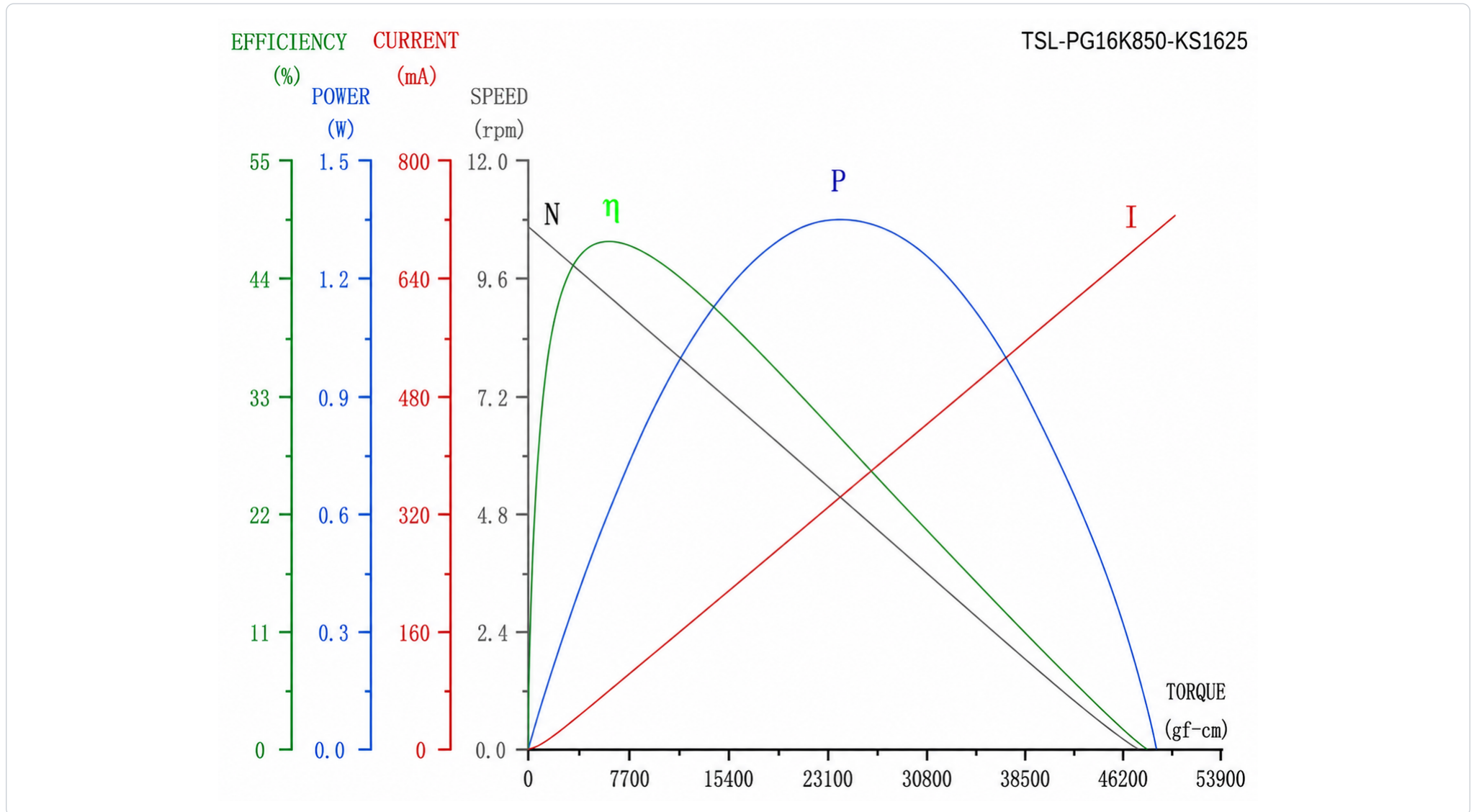

TSL-PG16K4592-KS1625

Speed, Current, Output Power and Efficiency vs. Torque

