

TSL-PG16-KW1636 Series

Micro DC Planetary Gear Motor - Product Specification



SERIES OVERVIEW

- Rated voltage: 12 V DC
- Available planetary ratios: 30:1, 157:1, 850:1 and 4592:1
- 16 mm planetary steel gearbox with coreless brushless DC motor
- Compact construction with dual ball-bearing output support

ELECTRICAL OPTIONS

| Model | Rated Voltage | Gear Ratios |
|-----------------|---------------|----------------|
| TSL-PG16-KW1636 | 12 V DC | 30:1 to 4592:1 |

All dimensions are in mm unless otherwise specified.

DIMENSIONAL DRAWING

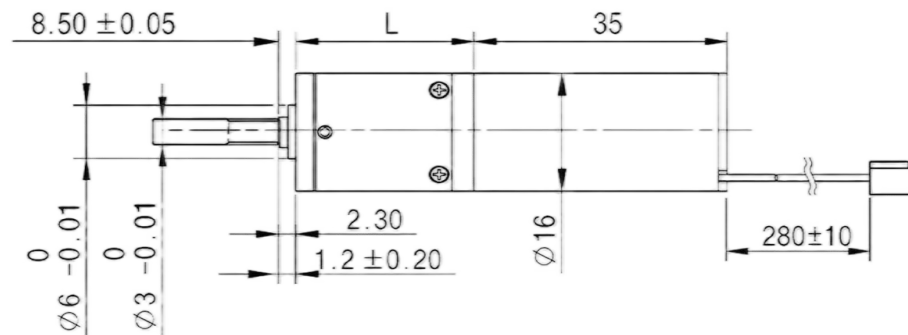
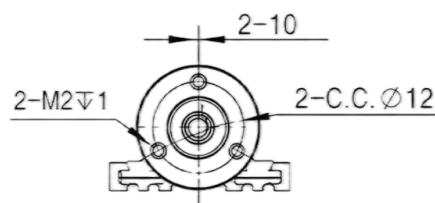

TSL-PG16-KW1636 Series

12 V DC - Performance Data by Gear Ratio

| Motor Model | TSL-PG16K30-KW1636 | TSL-PG16K157-KW1636 | TSL-PG16K850-KW1636 | TSL-PG16K4592-KW1636 |
|--|--------------------|---------------------|---------------------|----------------------|
| Reduction Ratio | 30 | 157 | 850 | 4592 |
| Rated Voltage (V) | 12 | 12 | 12 | 12 |
| No-Load Speed (rpm) | 412 | 76 | 14 | 3 |
| No-Load Current (mA) | 58.3 | 58.3 | 58.3 | 58.3 |
| No-Load Efficiency (%) | 21.38 | 17.09 | 13.70 | 8.35 |
| Speed at Maximum Efficiency (RPM) | 378 | 70 | 13 | 2 |
| Current at Maximum Efficiency (mA) | 644.0 | 641.6 | 647.0 | 651.4 |
| Torque at Maximum Efficiency (gf-cm) | 426 | 1832 | 79988 | 264662 |
| Output Power at Maximum Efficiency (W) | 1.65 | 1.32 | 1.06 | 0.65 |
| Stall Torque (gf-cm) | 5132 | 21992 | 966627 | 322131 |
| Stall Current (mA) | 7115 | 7062 | 7180 | 7278 |

Specifications are for reference only. Products can be customized according to customer requirements.

TSL-PG16K30-KW1636

Speed, Current, Output Power and Efficiency vs. Torque

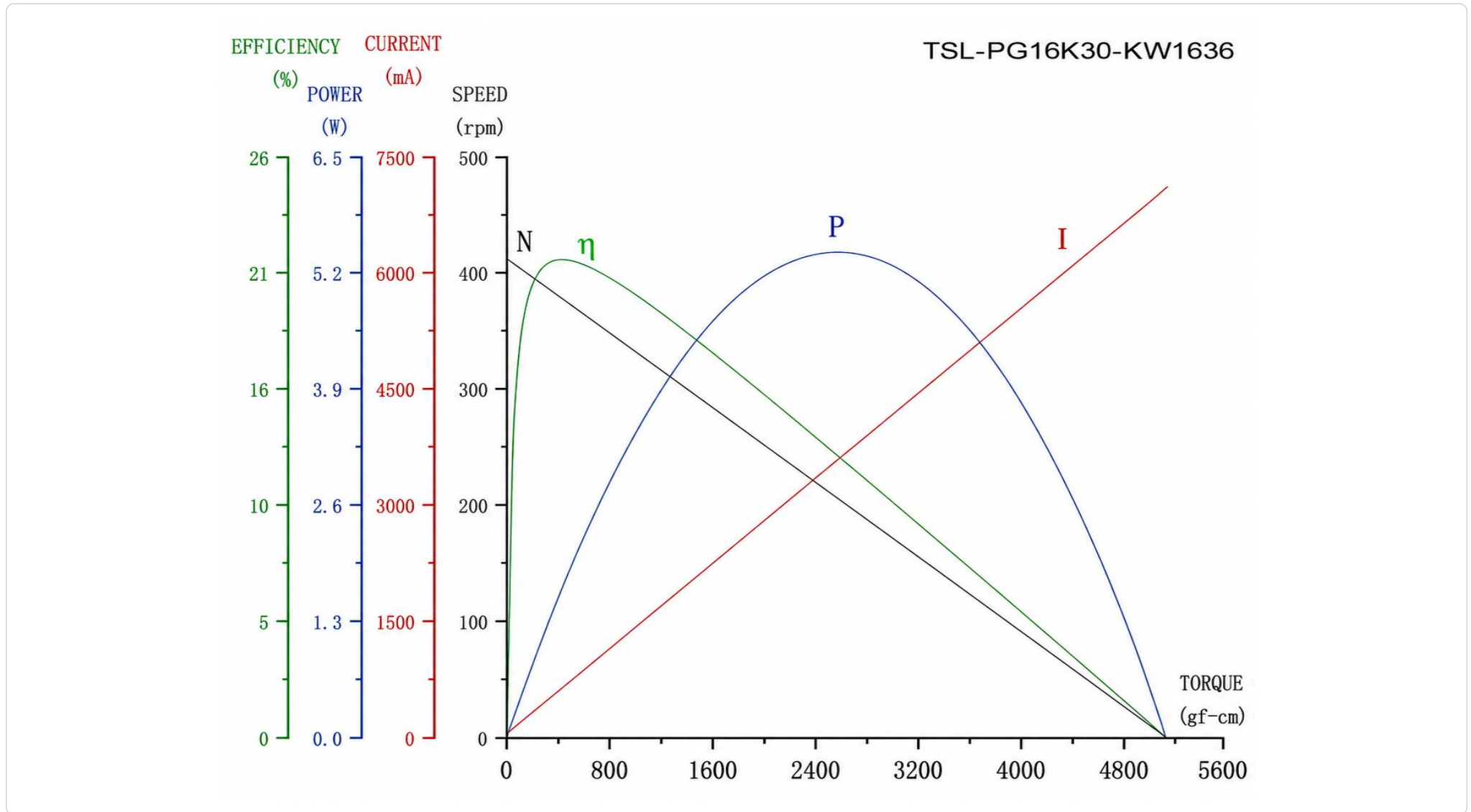

TSL-PG16K157-KW1636

Speed, Current, Output Power and Efficiency vs. Torque

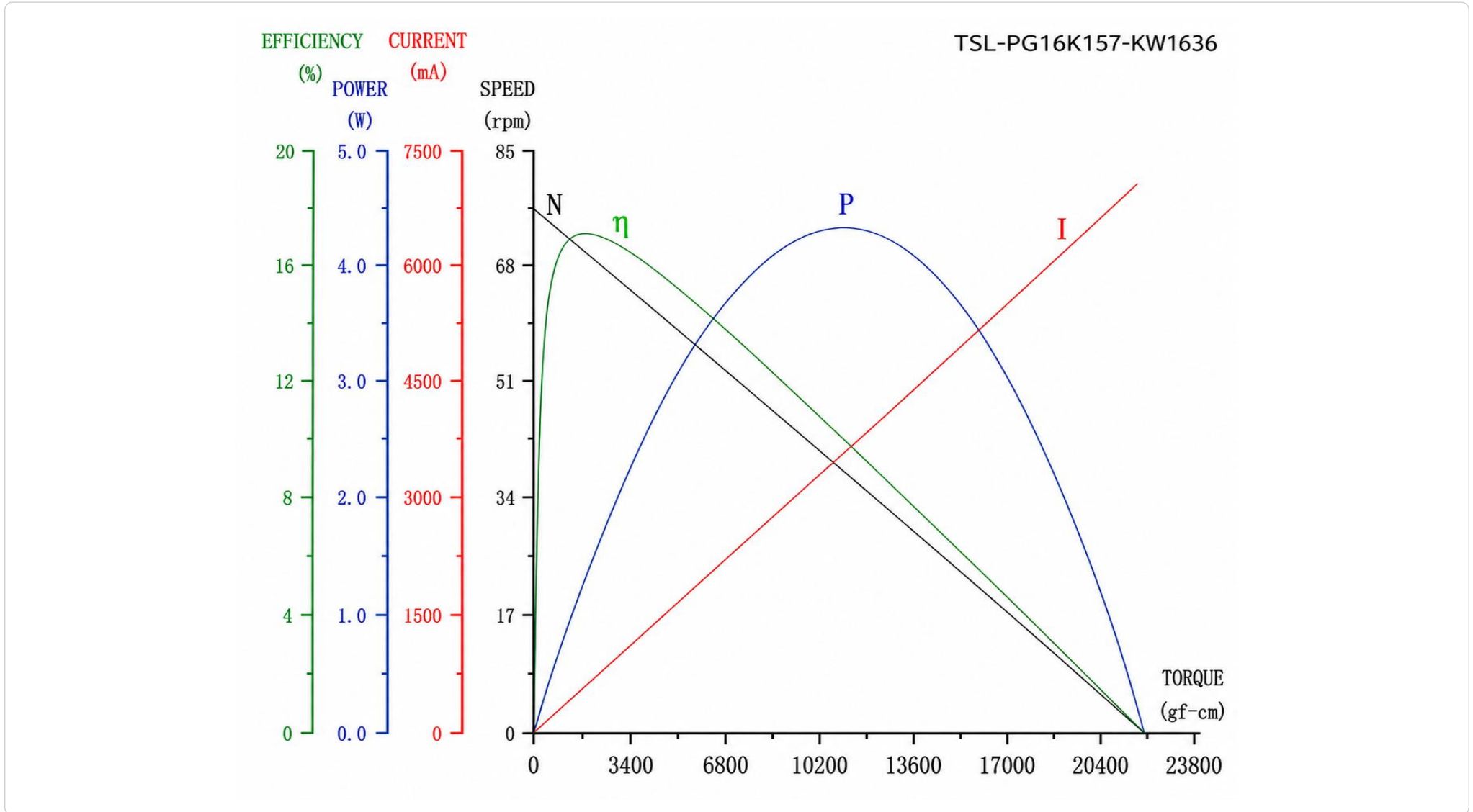

TSL-PG16K850-KW1636

Speed, Current, Output Power and Efficiency vs. Torque

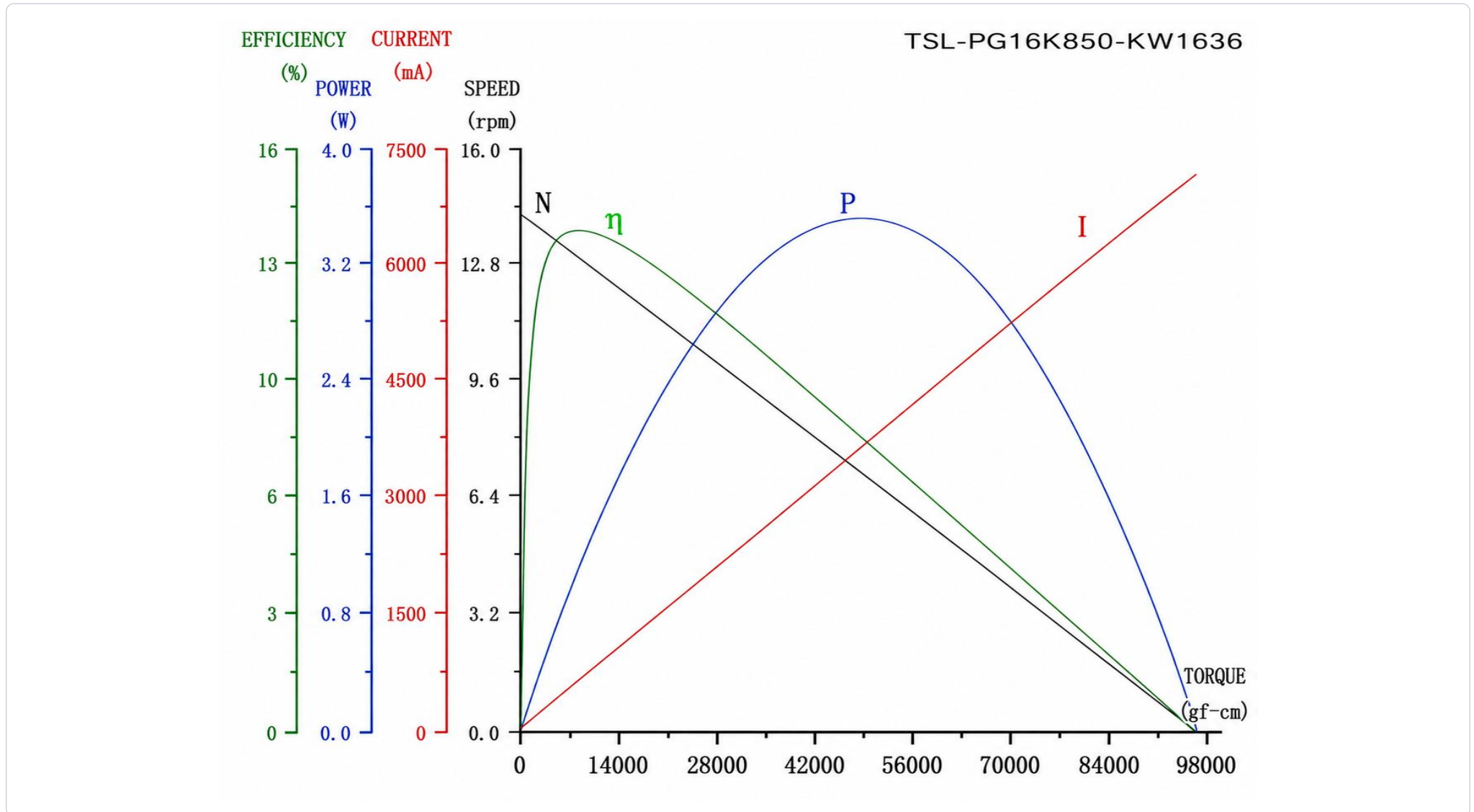

TSL-PG16K4592-KW1636

Speed, Current, Output Power and Efficiency vs. Torque

